

StarterBaffle 2in1™ by DCI

Instructions for use with rafters 16" and 24" on center

It is important to follow each step within these instructions for proper installation of the StarterBaffle™ product. Any deviation from these instructions will void any warranty written or implied by DCI Products. If you need assistance with product installation, call DCI Products Monday through Friday 8am - 5pm est. Our number is 610-622-4455 or contact us via email info@dciproducts.com

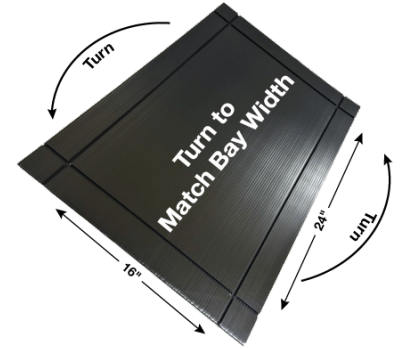

StarterBaffle 2in1 Directions

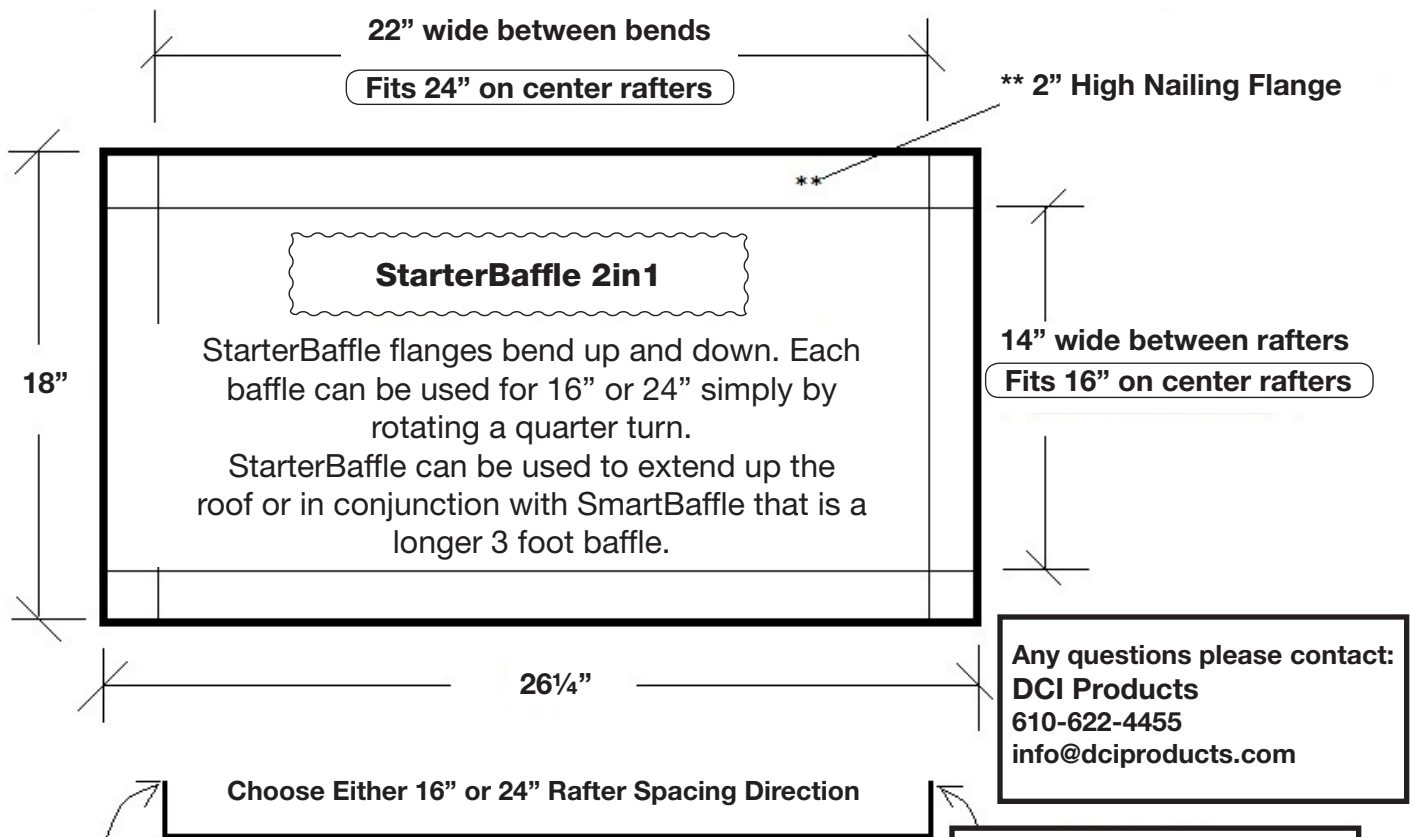

Directions: Flanges bend up and down. Use opposing flanges for either 16" or 24" direction. The routed lines can be up or down also. Use 3/4" nails or screws, or 1/2" staples to secure side flanges to rafters. Use a utility knife to cut around objects. Refer to SmartBaffle directions for further guidance.

Bend up to fit rafter space using roof top method or down using attic side method

StarterBaffle 2in1™ by DCI

Instructions for use with rafters 16" and 24" on center

It is important to follow each step within these instructions for proper installation of the StarterBaffle™ product. Any deviation from these instructions will void any warranty written or implied by DCI Products. If you need assistance with product installation, call DCI Products Monday through Friday 8am - 5pm est. Our number is 610-622-4455 or contact us via email info@dciproducts.com

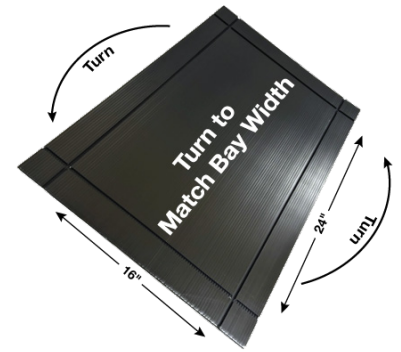

Installation Methods for StarterBaffle

Attic Side Installation Measuring Down 4" From Roof Deck to Bottom of 2" Flange

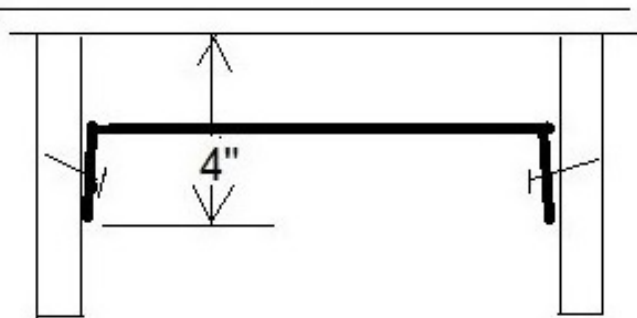

Roof Top Installation with Plywood Installed After StarterBaffle

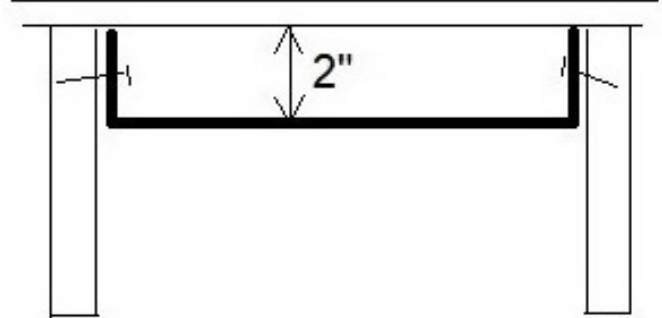

Attic Side Installation Measuring Down 4" From Roof Deck to Bottom of 2" Flange

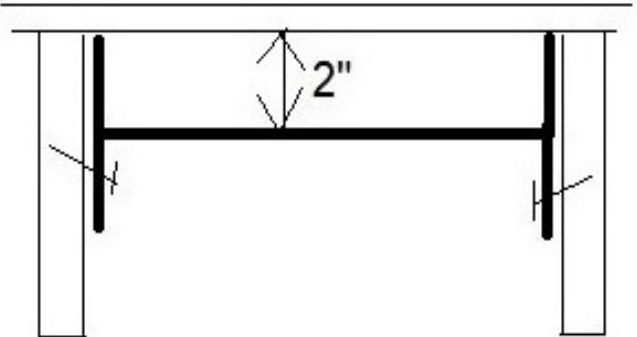

Attic Side Installation Nail Right Flange Against Roof Deck. Reverse Flange on Left Side Nailing Horizontal to Roof Deck

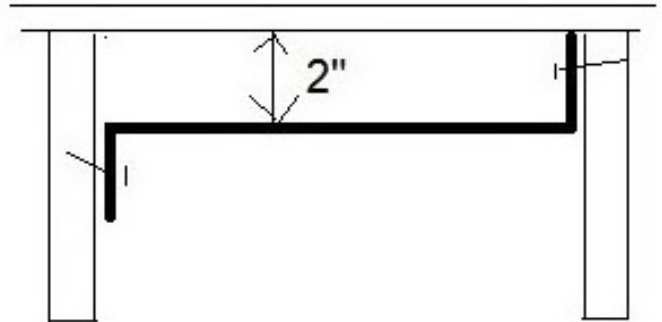

Use 1/2" staples, 1" screws or 1 1/4" roofing nails to attach StarterBaffle to side wood rafters. Cuts can easily be made with a retractable type utility knife. Bends can be made by cutting halfway through plastic on the side opposite the bend direction of choice.